

## How to submit a report on the eWasp app

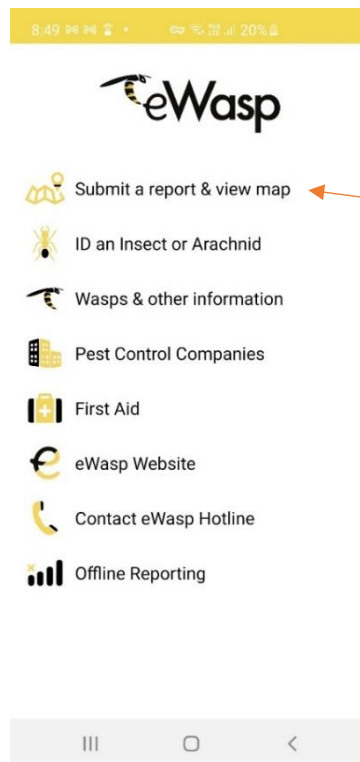

### 1. Main Menu



Select Submit a report & view map

### 2. Register

[Privacy Policy - eWasp](#)

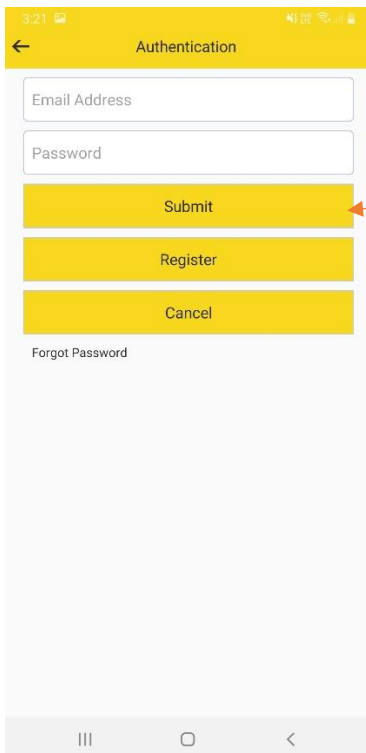

When you select to drop a pin for the first time, you will be prompted to register an account.

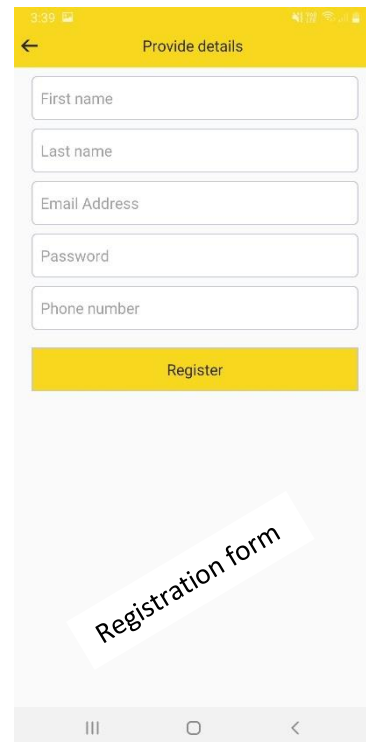

3.

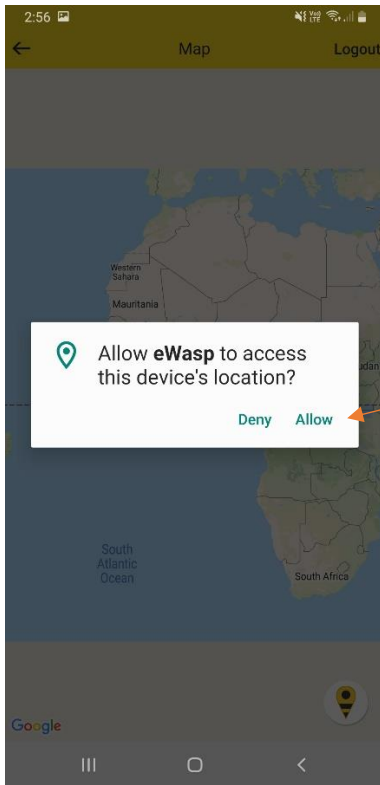

If you have just registered, this message will appear, Select Allow

4. Map page

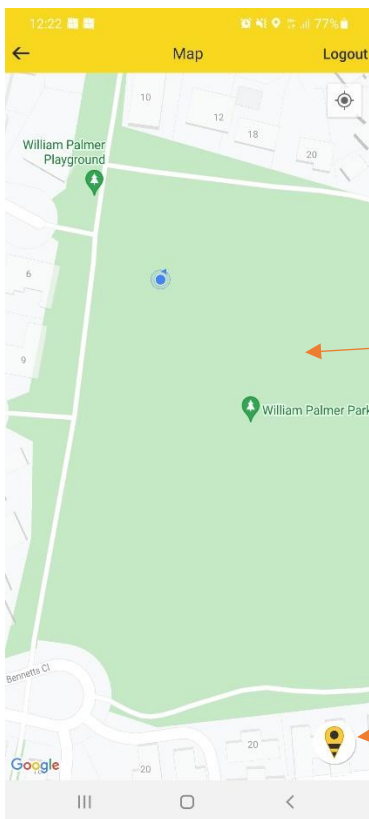

The map will appear. You can move around the map, zoom in and out, to view the location of pinned eWasp nests/sightings, honey bee hives/swarms, in your area.

This is where you also submit a report, see below.

To submit a report, tap on the yellow and black pin.

5.

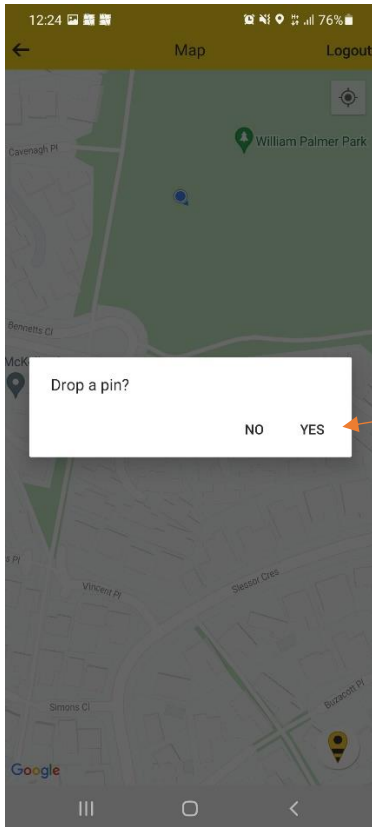

This message will appear, Select Yes

Tap the location of the nest on the map.

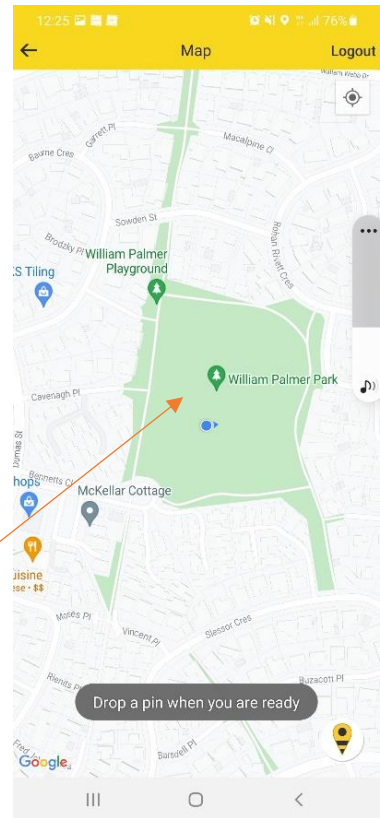

6. Drop a location pin



Once the pin has been dropped on the screen, you can zoom in for a more precise location

- press/hold the pin to move it to the exact location.

When you are happy with the location, tap/select the green tick.

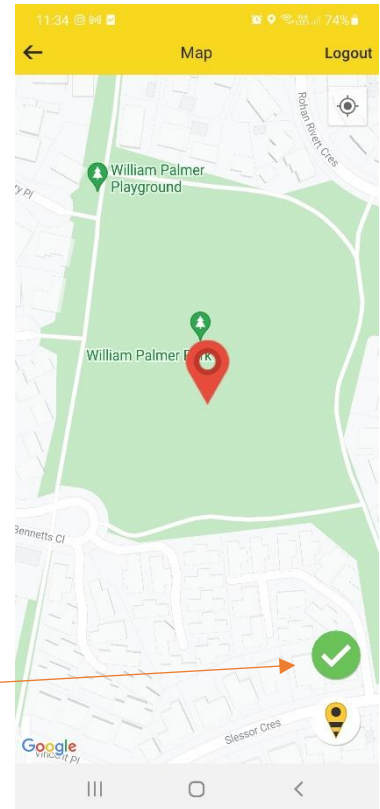

### 7. Report details

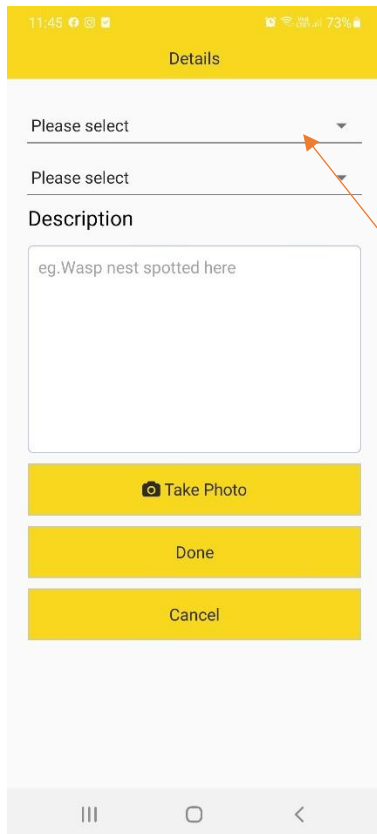

From the first dropdown, select land type.

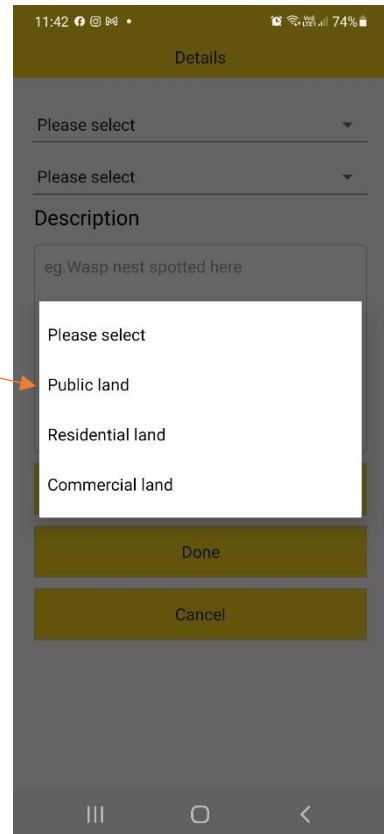

### 8.

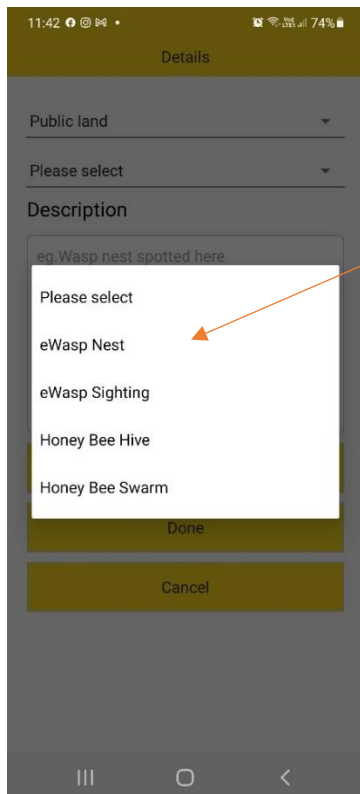

From the second dropdown, select report type

You can also add a description, see example, and take a photo of the location of the nest/area.

Next step is to select Done.

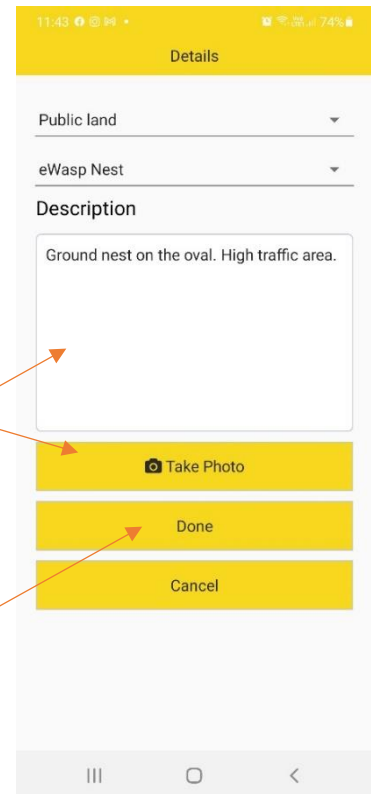

9.

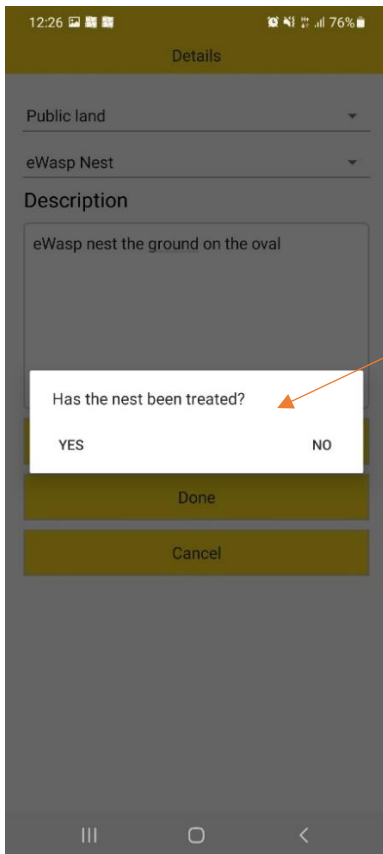

Select whether the nest has been treated.

Select o.k. to submit the report.

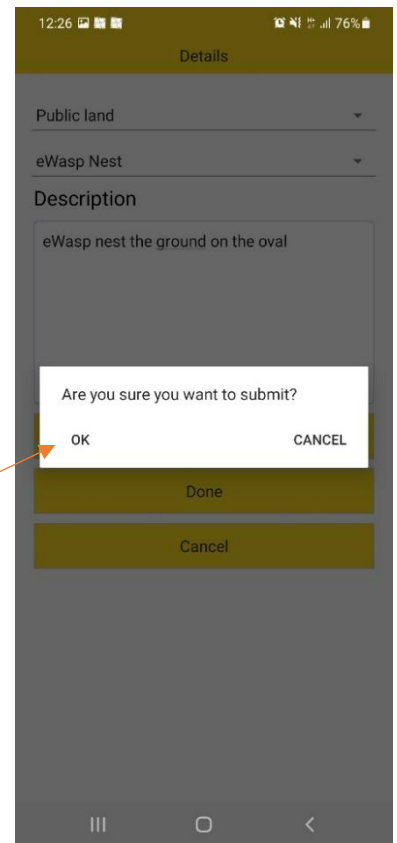

10.

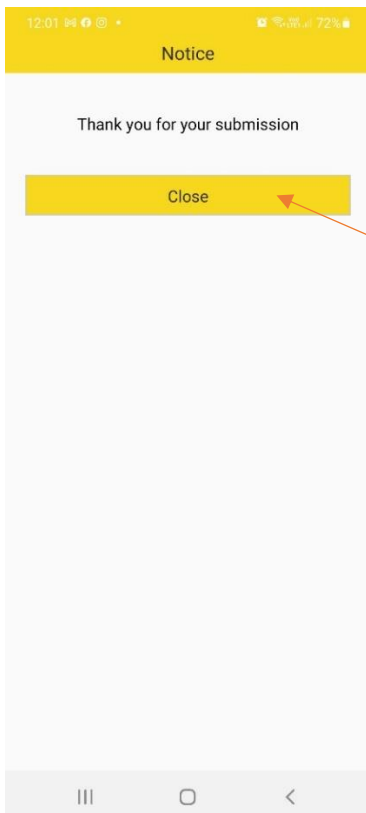

Done! An eWasp team member will receive the report to action.

If on public or commercial land, your pin/report will be visible on the eWasp app map.

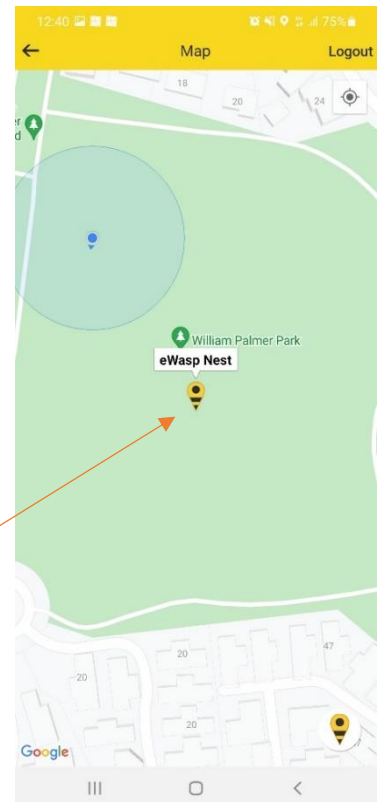

11.

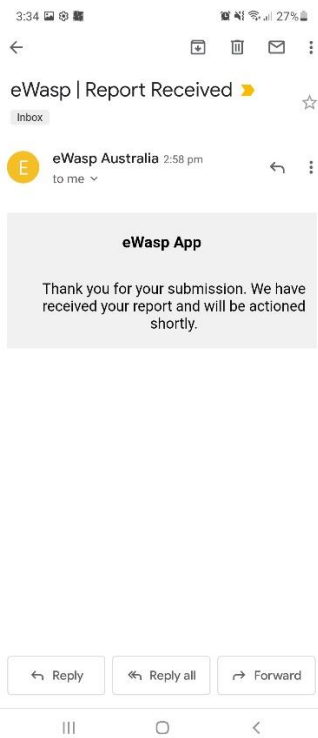

Your email confirmation

**New app capabilities coming soon:**

- State reporting,
- ACT Residential land reports will have a direct link to pest control companies upon submitting a report,
- Upload image capability for insect/arachnid Identification, and
- Comments section for offline/no service area reporting.

*The eWasp Team*



**European Wasp Hotline**

eWasp Hotline: 02 6258 5551

email: [info@ewasp.com.au](mailto:info@ewasp.com.au)

website: [www.ewasp.com.au](http://www.ewasp.com.au)



CoreEnviro  
SOLUTIONS

**CoreEnviro Solutions Pty Ltd**

email: [info@cesact.com.au](mailto:info@cesact.com.au)

website: [www.coreenvirosolutions.com](http://www.coreenvirosolutions.com)